

## Original design - MHL2 MHL2-10D2

### Datasheet

### General series information

- Maximum gripping force per finger 396 N at 0.5 MPa
- Double acting
- Repeatability:  $\pm 0.1$  mm
- Max. operating frequency: 60 c.p.m.

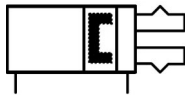

*Gripper, internal grip, double-acting with permanent magnet on piston*

### Standard specifications

Bore Size	10mm
Thread	(M5 Thread-10~25mm)(Rc-32~40mm)
Opening & Closing Stroke	2 (Extra Wide Opening)
Auto Switch	No Switch
Lead Wire or Prewired Connector	0.5m (Or None in the Case of No Switch)
Number	2 pcs. (Or None in the Case of No Switch)
Maximum operating pressure	0.6 MPa
Minimum operating pressure	0.15 Mpa
Maximum ambient temperature	60 °C
Minimum ambient temperature	-10 °C
Repeatability	$\pm 0.1$ mm
Lubrication	Not required
Effective holding force per finger (0.5 MPa)	14 N
Fluid	Air
Max. operating frequency	40 c.p.m.
Action	Double Acting
Gripping point distance	40 mm
Weight	0.427 Kg

# Dimensions

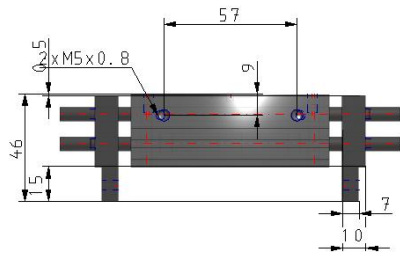
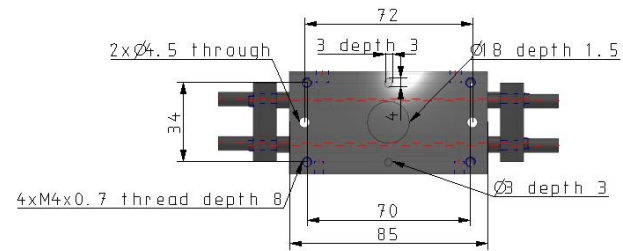
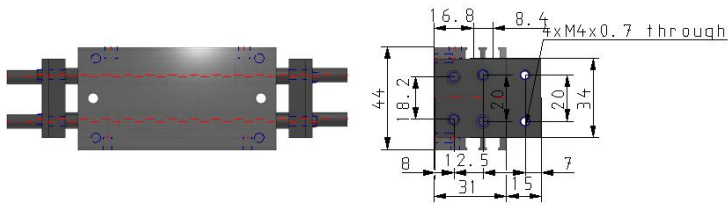
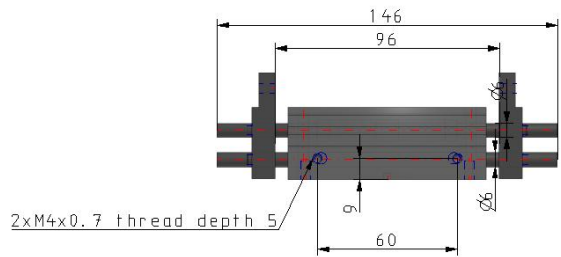
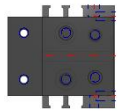

## Additional information

Catalogue	<a href="#">MHL2_EU.pdf</a>
Operation manuals	<a href="#">OM_MHL2_OMC0028EN.pdf</a>