

ARM11A, Regulator Block, Common Supply Type

ARM11AB2-R17-A

Datasheet

General series information

- Regulator block, common supply type
- OUT piping type: straight & elbow (metric & inch)
- OUT piping position: bottom, top
- Handle position: top, bottom, front
- Accessories: pressure gauge
- Options: 0.35MPa setting, non-relieving, oil free

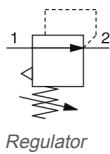

Standard specifications

| | |
|---|--------------------------------|
| Handle Position | B (Front) |
| Piping | 2 (Upper) |
| Fitting | 17 (Ø6 Elbow) |
| Accessory | A (Pressure Gauge) |
| Option | None |
| Unit | Name Plate, Pressure Gauge MPa |
| Digital Pressure Switch Output Specifications | None |
| Maximum temperature of pressure medium | 60 °C |
| Minimum temperature of pressure medium | -5 °C (with no freezing) |
| Maximum operating pressure | 1.0 MPa |
| Proof pressure | 1.5 MPa |
| Set pressure range | 0.05 - 0.7 MPa |
| Applicable fluid | Air |
| Regulator construction | Direct acting |
| Working principle | Piston type |
| Relief mechanism | Relieving type |
| Weight | 0.102 Kg |

Dimensions

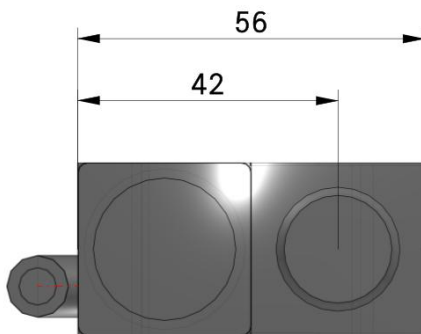
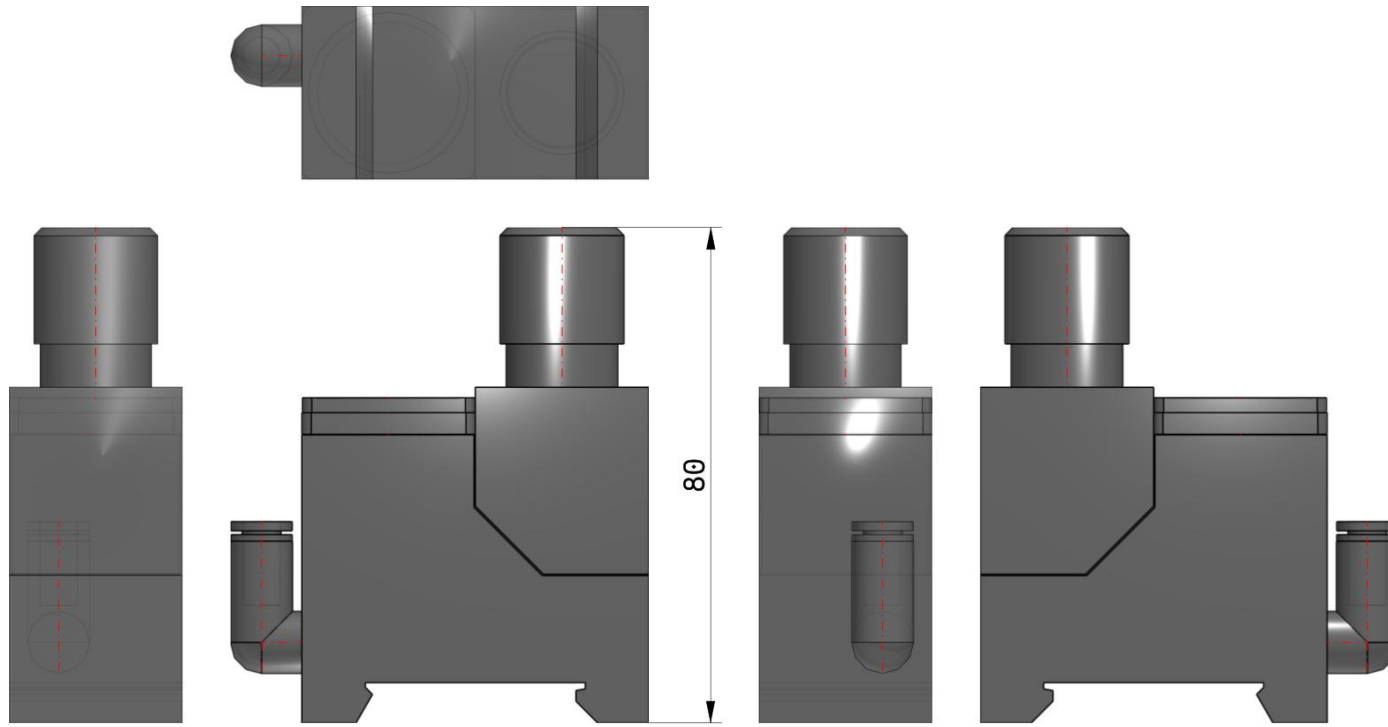

Additional information

Catalogue

[ARM10-11_EU.pdf](#)

Operation manuals

[arm10_11_op_man_ar_-omg0039-a.pdf](#)