

ZU*A, In-line Type Vacuum Ejector ZU05SA

Datasheet

General series information

- Maximum flow rate: 16 l/min (ANR).
- Maximum vacuum pressure: -90 kPa.
- Nozzle diameters: 0.3, 0.4, 0.5 and 0.7 mm.
- Dimensions: Overall length 47 to 59 mm. Ø 8.2 to 10.4 mm.
- Weight: 2.4 to 4.3 g.

Vacuum ejector

Standard specifications

| | |
|-----------------------------|--|
| Nozzle Diameter | 05 (0.5mm) |
| Vacuum Pressure | S [-85 kPa (ZU03), -87 kPa (ZU04), -90 kPa (ZU05/07)] |
| Port Size | ø4 One-touch Fitting (ZU03, ZU04), ø6 One-touch Fitting (ZU05, ZU07) |
| Usable tubing material | FEP, PFA, Nylon, Soft nylon, Polyurethane |
| Standard supply pressure | 0.45 MPa |
| Air consumption | 14 l/min (ANR) |
| Maximum suction flow rate | 13 l/min (ANR) |
| Operating temperature range | -5 to 50 °C (no freezing) |
| Fluid | Air |
| Pressure range | 0.1 to 0.6 MPa |

Dimensions

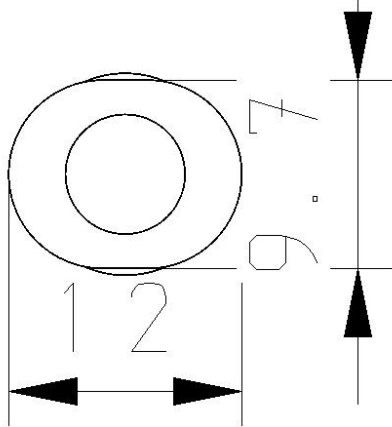
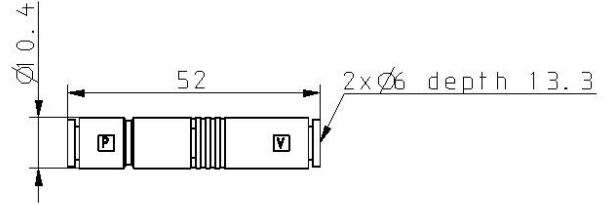
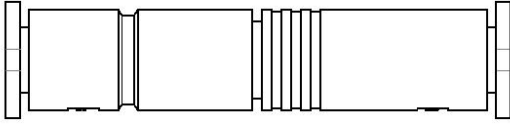

Constructions

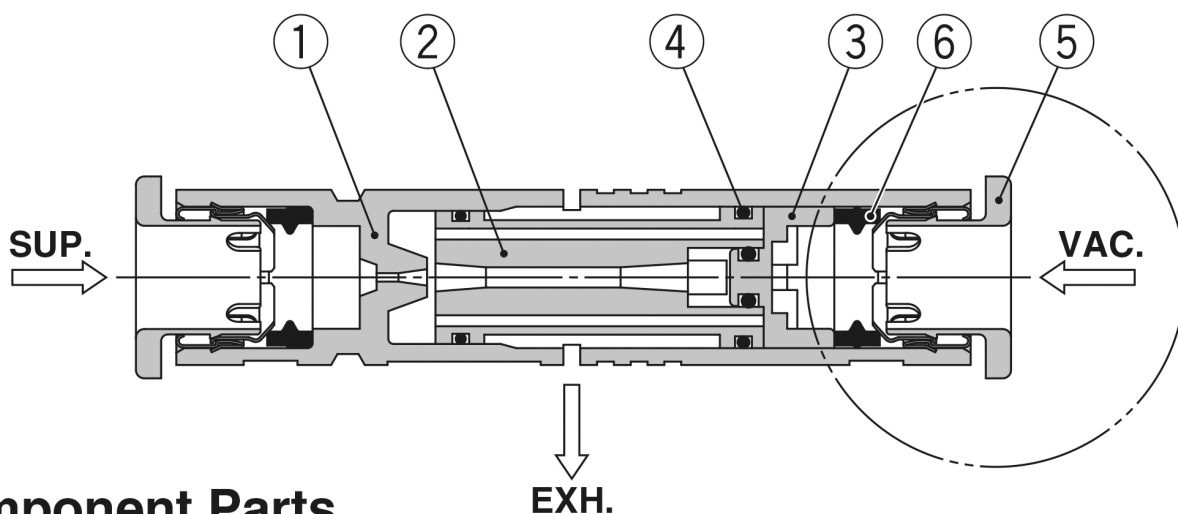

Component Parts

| No. | Description | Material | Note |
|-----|----------------------|----------|------------------------------|
| 1 | Body | Resin | |
| 2 | Diffuser | Resin | Type S: White, Type L: Black |
| 3 | Cap | Resin | |
| 4 | O-ring | NBR | Grease applied |
| 5 | Cassette | — | |
| 6 | Seal | NBR | Grease applied |
| 7 | Screw-in stud | Brass | Electroless nickel plating |

Screw-in type

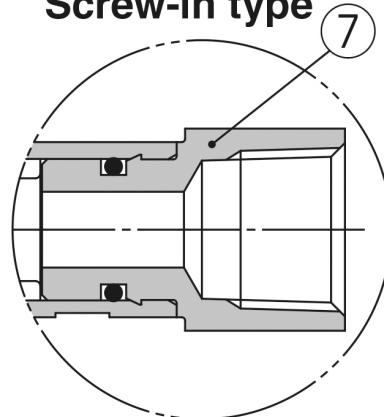

Additional information

Catalogue

[ZU_A-B_EU.pdf](#)