

Elbow - AS*2*1F AS3201F-03-08S

Datasheet

General series information

- Port Size: M3, M5, 10-32 UNF, 1/8, 1/4, 3/8, 1/2
- Applicable Tubing O.D.: Ø 2 to Ø 12 mm and Ø 1/8" to Ø 1/2"
- Operating Pressure Range: 0.1 to 1 MPa.

Standard specifications

Size	3 (3/8 Basis)
Style	2 (Elbow)
Control Method	0 (Meter-out)
Thread	M3, M5, U10/32, Rc
Port Size	03 (3/8)
Tube Size	Ø8
Option	S (Sealant)
Fixed Orifice	None
Made to Order	None
Lock Nut	Standard (Hexagon)
Weight	0.057 Kg

Dimensions

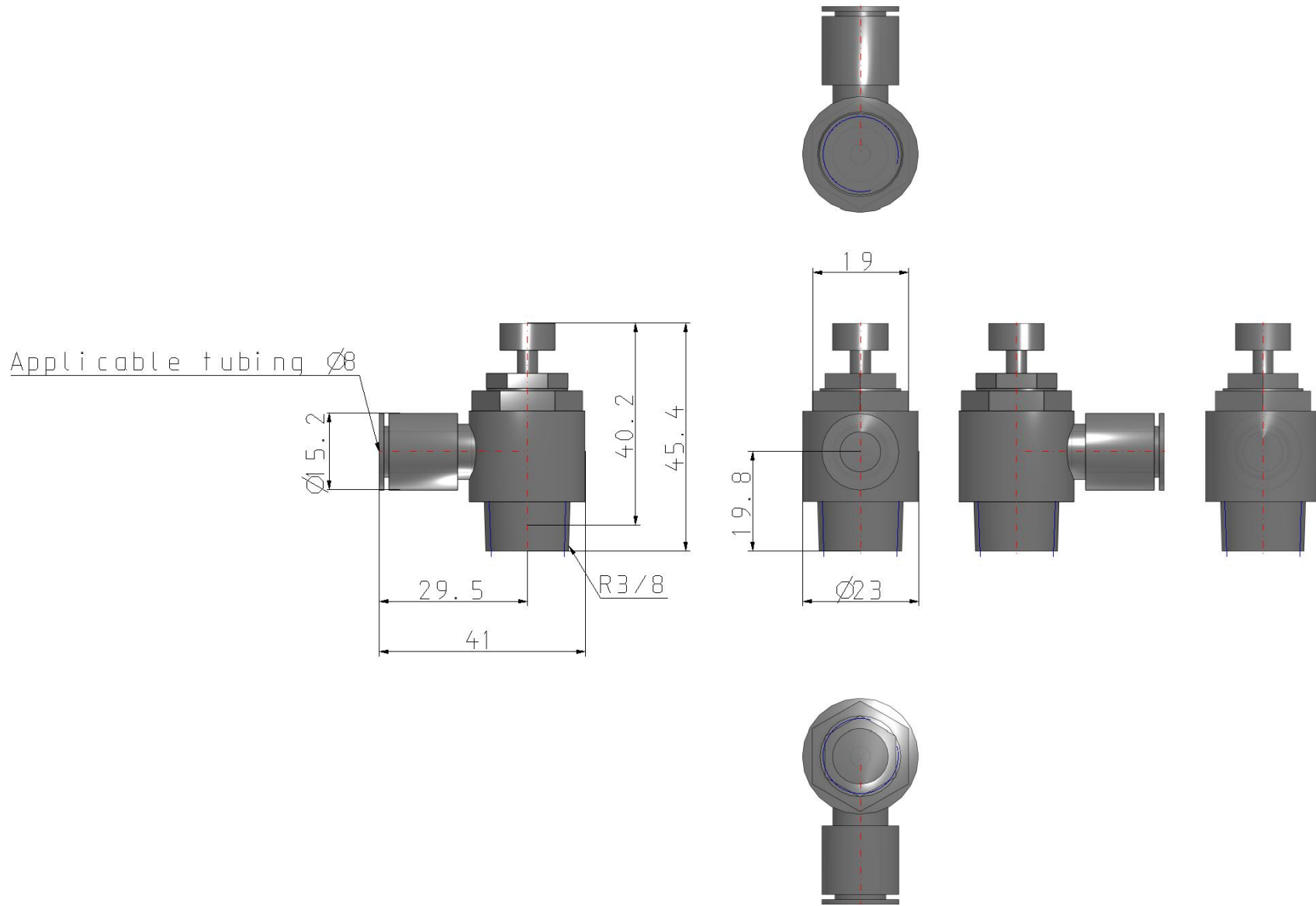

Specifications are subject to change without prior notice and any obligation on the part of the manufacturer.

Additional information

Catalogue

[AS_2-3_1F-A_EU.pdf](#)

Operation manuals

[OM_ASx2x1F_OMG0107EN-B.pdf](#)