

D-A90/A93/A96, Reed Switch, Direct Mounting, Grommet, In-line D-A90

Datasheet

- Electrical entry: Grommet.
- Application Load: IC circuit/Relay/PLC, 24V DC Relay/PLC.
- Power voltage: 100VAC/48V DC (4 to 8V DC).
- Load current: 5 to 50mA.
- Applicable Actuator Series: CDU, CDQS, CDQ2, MY1, MXU, MXW, MXF, MXS, MXQ, MXP, MTS, CXT, MK, MK2, RSQ, CEP, CY1R.

Standard specifications

Model	A90 (DC Volt <48, AC Volt <100)
Lead Wire Length	0.5 m
Approvals	CE
Electrical entry direction	In-line
Applicable load	IC circuit, Relay, PLC
Internal resistance	1 Ω
Load voltage	≤ 24 V (50 mA), ≤ 48 V (40 mA), ≤ 100 V (20 mA)
Load current	50 mA (≤ 24 V), 40 mA (≤ 48 V), 20 mA (≤ 100 V)
Weight	0.005 Kg

Dimensions

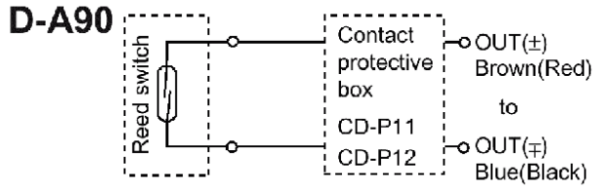

D-A90 *変更品

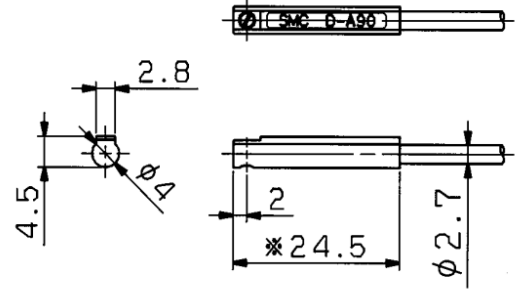

Additional information

Catalogue	D_EU.pdf
Declaration of conformity	newDoC_D-Reed_TF1V311EN.pdf DoC_DxZZ-TF0001M-B.pdf
Installation manuals	IMM_D-A9x_TFP24EN.pdf