

## Universal - AS\*3\*1F AS2301F-01-08

### Datasheet

### General series information

- Port Size: M3, M5, 10-32 UNF, 1/8, 1/4, 3/8, 1/2
- Applicable Tubing O.D.: Ø 3.2 to Ø 12 mm and Ø 1/8" to Ø 1/2"
- Operating Pressure Range: 0.1 to 1 MPa.

### Standard specifications

Size	2 (1/8, 1/4 Basis)
Style	3 (Universal)
Control Method	0 (Meter-out)
Thread	M3, M5, U10/32, Rc
Port Size	01 (1/8)
Tube Size	Ø8
Option	None
Fixed Orifice	None
Made to Order	None
Lock Nut	Standard (Hexagon)
Weight	0.036 Kg

# Dimensions

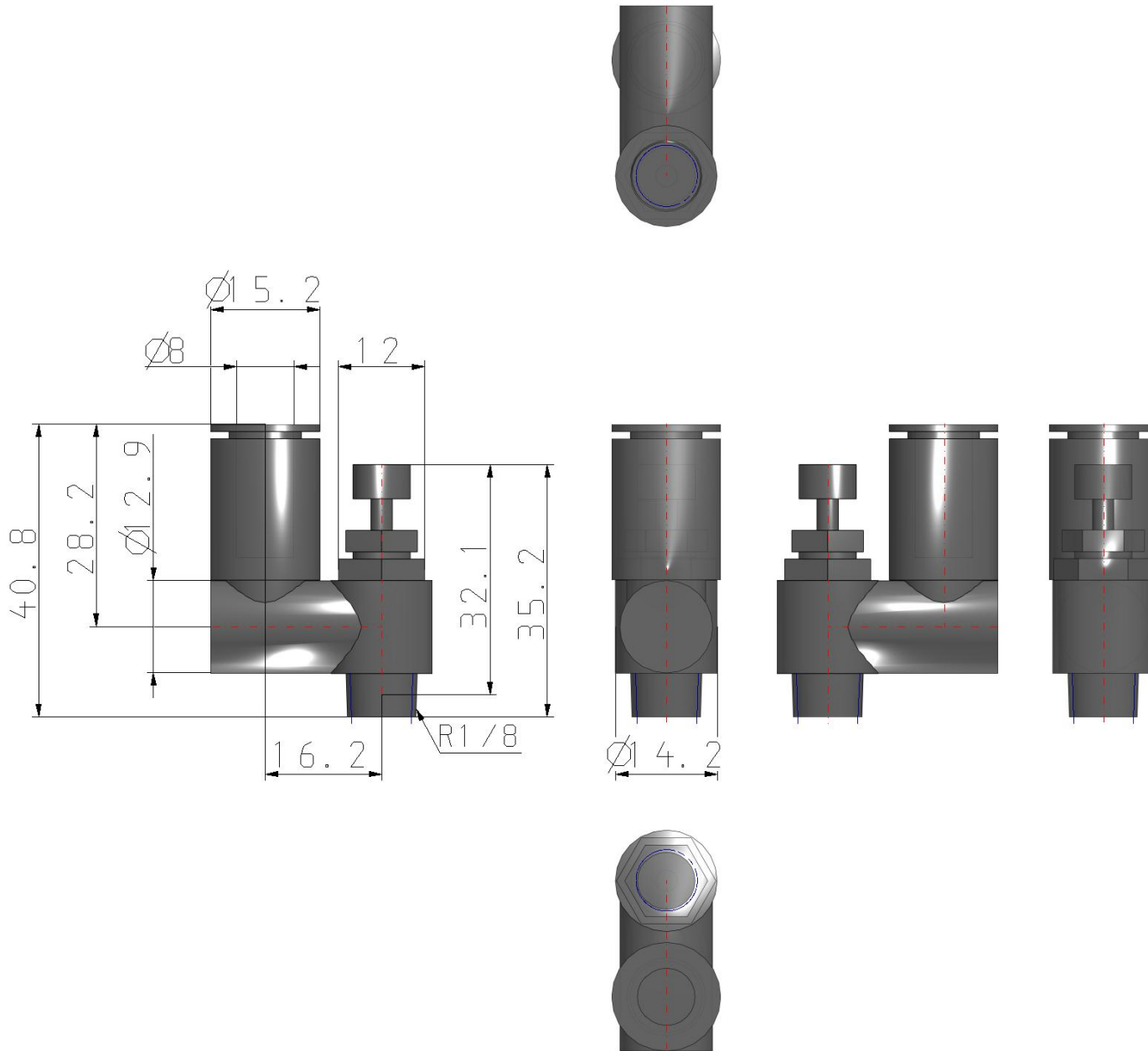

Specifications are subject to change without prior notice and any obligation on the part of the manufacturer.

## Additional information

Catalogue

[AS\\_2-3\\_1F-A\\_EU.pdf](#)