

KK130P-*H, S-Couplers, Straight Type with One-touch Fitting KK130P-06H

Datasheet

General series information

- Straight Type with One-touch Fitting.
- Applicable Tubing O.D.: $\varnothing 6$, $\varnothing 8$, $\varnothing 10$, $\varnothing 12$, $\varnothing 1/4$, $\varnothing 5/16$, $\varnothing 3/8$, $\varnothing 1/2$.

Standard specifications

Applicable Tubing O.D.	$\varnothing 6$ mm
Pressure medium	Air
Maximum operating pressure	1.5 MPa
Minimum operating pressure	0 MPa
Proof pressure	2 MPa
Maximum ambient temperature	80 °C
Minimum ambient temperature	-20 °C (No freezing)
Sealing principle	Male thread with sealant
Plating	Sleeve: Electroless nickel plated Other external metal parts: Zinc chromated
Weight	0.024 Kg

Dimensions

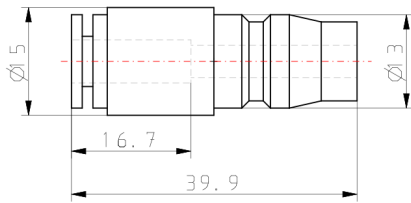

Additional information

Catalogue

[KK130-B_EU.pdf](#)