

EX260, Integrated Type (For Output) Serial Transmission System EX260-SEC3

Datasheet

General series information

- Centralised & compact serial transmission system for output
- Compatible protocols: PROFI-safe, Ethernet POWERLINK, PROFINET, EtherNet/IP™, EtherCAT®, PROFIBUS DP, DeviceNet™, CC-Link, IO-Link, CANopen, Modbus, AS-Interface
- Up to 32 solenoids, up to 24 stations
- Applicable valve series: new SY, VQC, S0700, SV
- Up to IP67 enclosure compliant.

Standard specifications

Protocol	EC (EtherCAT®)
Output Polarity/Communication Connector	3 [16 Outputs, -COM (PNP), M12 Connector]
Maximum ambient temperature	50 °C
Minimum ambient temperature	-10 °C
General power supply	24 VDC
Approvals	CE marking, UL (CSA) compatible
Weight	0.200 Kg

Dimensions

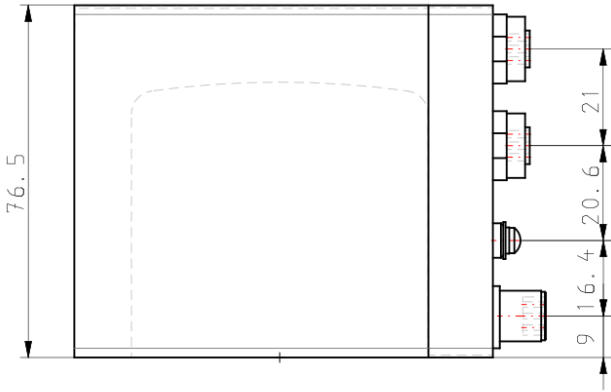
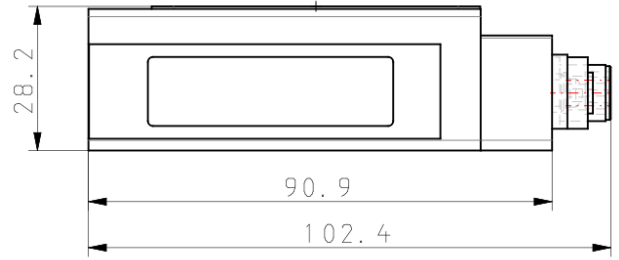
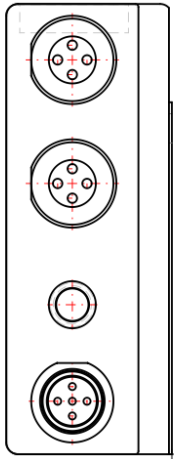

Additional information

Catalogue	EX260-D_EU.pdf
Declaration of conformity	newDoC_EX260_EN-A.pdf newDoC_EX260_PROFIsafe_EN-C.pdf newDoC_EX260_PROFIBUS_DeviceNet_EtherCAT_PROFINET_EtherNetIP_EtherNet-POWERLINK_CC-Link_EN-A.pdf
Installation manuals	IM_EX260_EtherNet_POWERLINK_EN.pdf IM_EX260_DeviceNet_EN.pdf IM_EX260_CC-Link_EN.pdf IM_EX260_PROFINET_EN.pdf IM_EX260_IO-Link_EN.pdf IM_EX260_EtherNetIP_EN.pdf IM_EX260_PROFIsafe_EN.pdf IM_EX260_EtherCAT_EN.pdf
Operation manuals	OM_EX260_CC-Link_EN-I.pdf OM_EX260_IP_Address_Setting_Tool_EX9-ZSW-IPC1_EN-A.pdf Quick_guide_EX260_EtherNet_POWERLINK_EN.pdf OM_EX260_EtherNet_POWERLINK_EN-A.pdf OM_EX260_IO-Link_EN-A.pdf OM_EX260-SDN_DeviceNet_EN-J.pdf OM_EX260-SEC_EtherCAT_EN-G.pdf OM_EX260_PROFIBUS_EN-H.pdf Quick_guide_EX260_CC-Link_EN.pdf Quick_guide_EX260_PROFINET_EN.pdf OM_EX260_PROFINET_EN-E.pdf OM_EX260_PROFIsafe_EN-A.pdf OM_EX260-SEC_EtherNetip_EN-G.pdf OM_EX260_IP_Address_Setting_Tool_EX9-ZSW-IPC1_EN-A.pdf
29/08/2024	

Specifications are subject to change without prior notice and any obligation on the part of the manufacturer.