

## CXSWM, Dual Rod Cylinder, Double Rod, Slide Bearing CXSWM15-50

### Datasheet

Series CXS is available in six bore sizes and stroke lengths up to 100mm. This series is very compact and has a very accurate non-rotating specification. It is suited for accurate pick-and-place applications or light duty material handling. The CXS can be used with either reed or solid state switches. Available in clean room versions.

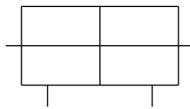

Double-acting cylinder with double piston rod

### Standard specifications

Thread port	M5 (Rc (PT) for sizes 25 to 32)
Bore Size	15mm
Stroke	50mm
Auto Switch	No Switch
Number	2 pcs. [Or None in the Case of No Switch]
Pressure medium	Compressed Air
Maximum temperature of pressure medium with magnet	60 °C
Minimum temperature of pressure medium with magnet	-10 °C [without condensation]
Maximum operating pressure	0.70 MPa
Minimum operating pressure	0.15 MPa
Proof pressure	1.05 MPa
Maximum ambient temperature with magnet	60 °C
Minimum ambient temperature	-10 °C
Numero of pneumatic connections	2 pcs.
Pneumatic input connection	M5 x 0.8
Pneumatic output connection	M5 x 0.8
Mode of operation of drive	Double acting
Theoretical cylinder force, advance stroke (at 0.5 MPa)	126 N
Theoretical cylinder force, return stroke (at 0.5 MPa)	126 N
Maximum piston speed	500 mm/s
Type of cushioning	Rubber bumper

Maximum stroke reduction per side	5 mm
Type of stroke reduction	Both sides
Tolerance of torsion	0.2°
Weight	0.600 Kg

## Dimensions

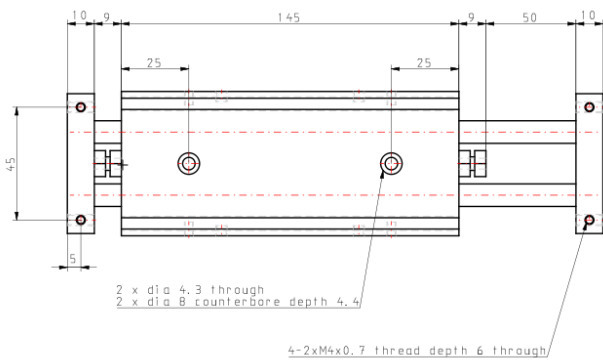
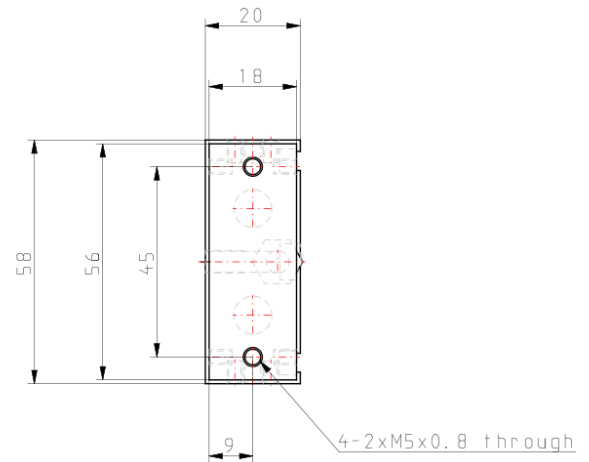
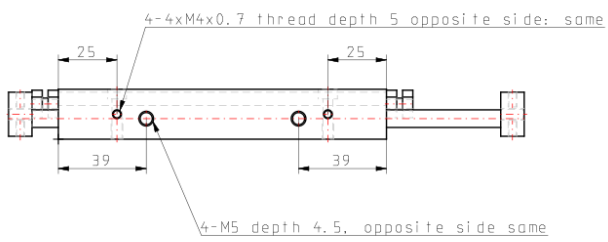

## Constructions

### CXSWM Slide bearing

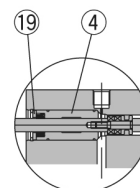
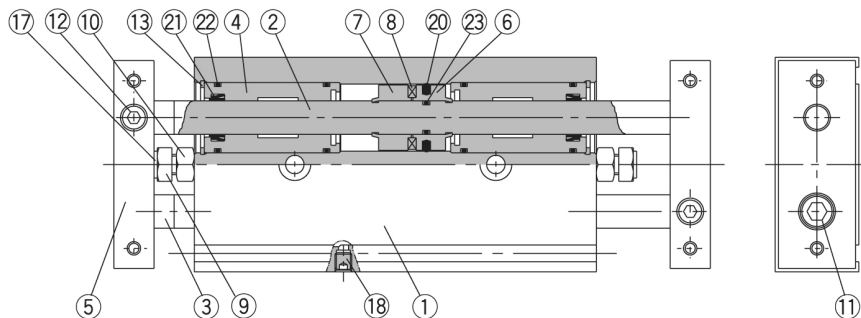
**CXSWM6**

### CXSWL Ball bushing bearing

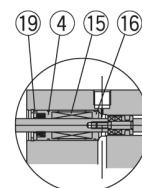
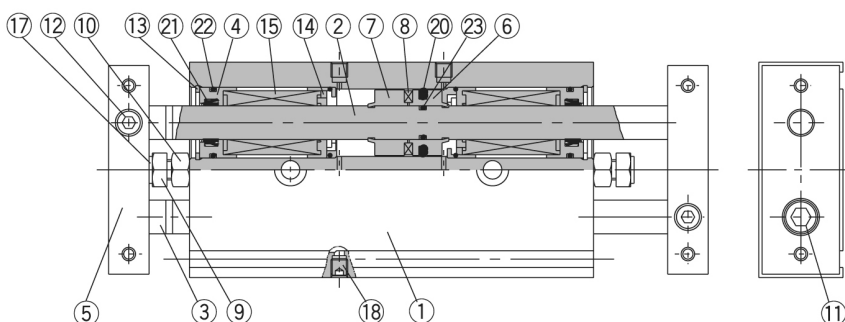
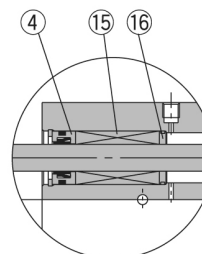
**CXSWL6**

**CXSWL10, 15**

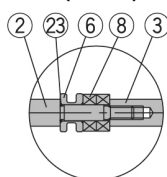
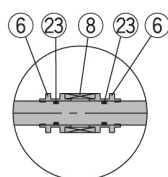
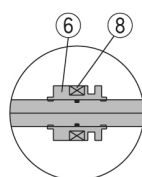
#### (Piston)

**CXSW□6**

**CXSW□10**

**CXSW□25, 32**

#### Parts list

No.	Description	Material	Note
1	<b>Housing</b>	Aluminum alloy	Hard anodized
2	<b>Piston rod A</b>	Carbon steel	Hard chrome plated
3	<b>Piston rod B</b>	Carbon steel	Hard chrome plated
4	<b>Rod cover/Bearing</b>	Aluminum alloy	
5	<b>Plate</b>	Aluminum alloy	Hard anodized
6	<b>Piston A</b>	Aluminum alloy	Chromated
7	<b>Piston B</b>	Aluminum alloy	Chromated
8	<b>Magnet</b>	Magnetic material	
9	<b>Bumper bolt</b>	Carbon steel	Nickel plated
10	<b>Hexagon nut</b>	Carbon steel	Nickel plated
11	<b>Hexagon socket head cap screw</b>	Chromium steel	Nickel plated
12	<b>Hexagon socket head set screw</b>	Chromium steel	Nickel plated

Note) Piston rod for CXSWL is quenched.

#### Parts list

No.	Description	Material	Note
13	<b>Snap ring</b>	Special steel	Nickel plated
14	<b>Bumper holder</b>	Synthetic resin	
15	<b>Ball bushing</b>	—	
16	<b>Bearing spacer</b>	Synthetic resin	
17	<b>Bumper</b>	Polyurethane	
18	<b>Plug</b>	Chromium steel	Nickel plated
19	<b>Seal retainer</b>	Aluminum alloy	
20*	<b>Piston seal</b>	NBR	
21*	<b>Rod seal</b>	NBR	
22*	<b>O-ring</b>	NBR	
23	<b>O-ring</b>	NBR	

\* Seal kits consist of items 20 through 22, and can be ordered by using the seal kit number corresponding to each bore size. However for CXSWL15, there are two types of O-ring (22). For other sizes, one type of O-ring is available. For CXSWL6, aluminum alloy is used for 16.

## Additional information

Catalogue

[CXS\\_EU.pdf](#)