

## C(D)JP2, Pin Cylinder, Double Acting, Single Rod

### CDJP2D16-30D

- The body material has been changed from brass to aluminium, achieving impressive weight reduction.
- The overall length of the cylinder has been reduced resulting in an extremely compact cylinder.
- Solid state auto-switches can also be mounted now.
- Longer stroke options are now available.
- Internal rubber bumpers provide quieter operation and longer life (up to 5 million cycles).

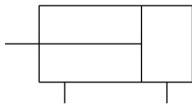

Double-acting, single-rod cylinder

Magnet	D (Built-in)
Mounting	D (Clevis)
Bore Size	Ø16 mm
Stroke	30 mm
Rod End Thread	With Thread
Auto Switch	No Switch
Lead Wire or Prewired Connector	0.5m [Or None in the Case of No Switch]
Number	2 pcs. [Or None in the Case of No Switch]
-	Compressed Air
Maximum temperature of pressure medium with magnet	60 °C
Minimum temperature of pressure medium with magnet	-10 °C
Maximum operating pressure	0.7 MPa
Minimum operating pressure	0.06 MPa
Proof pressure	1.05 MPa
Maximum ambient temperature with magnet	60 °C
Minimum ambient temperature with magnet	-10 °C
Pneumatic input connection	M5 x 0.8
Theoretical cylinder force, advance stroke (at 0.5 MPa)	100.5 N
Theoretical cylinder force, return stroke (at 0.5 MPa)	86.4 N

Type of cushioning	Rubber bumper
Male thread of rod end	M5

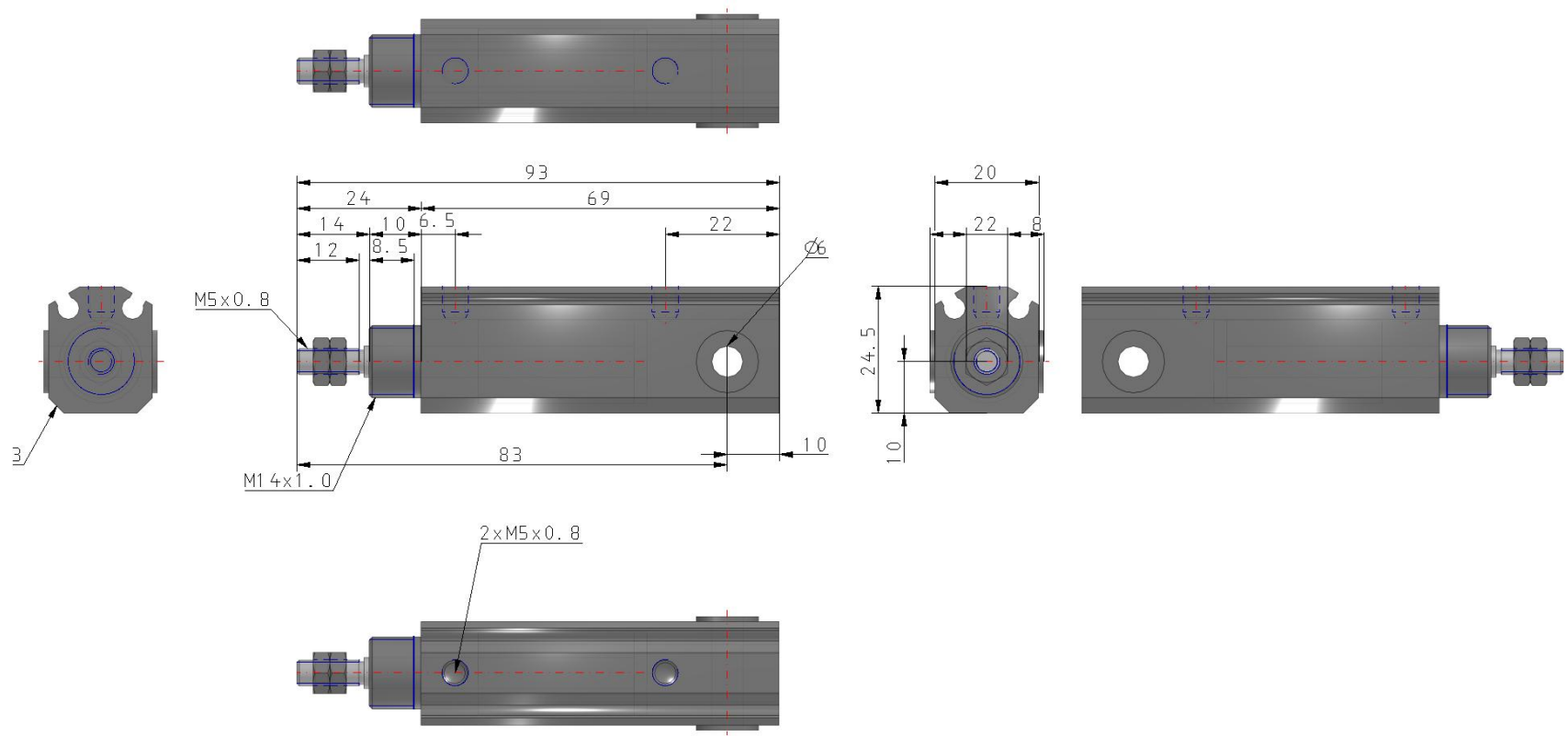

- 
- [CJP2-CJP\\_EU.pdf](#)
- [cjp2\\_op\\_manual\\_cjp2-om0002k.pdf](#)