

C(D)RA1-Z*30-100, Rotary Actuator, Rack & Pinion, Standard CRA1BSU80TF-90Z

Datasheet

General Series Information

- Rotary actuator
- Sizes: 30, 50, 63, 80, 100
- Rotating angle: 90°, 100°, 180°, 190°
- Adjustable rotation time range: from 0.2 to 5 s/90°.

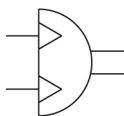

Semi-rotary actuator, double acting

Standard specifications

Magnet	None
Mounting	B (Basic)
Shaft Type	S (Single Shaft)
Angle Adjusting Unit	U (Angle Adjuster)
Type	Pneumatic
Size	80 mm
Port Thread	TF (G)
Rotation Angle	90°
Type of Cushioning	None
Auto Switch	No Switch
Lead Wire or Prewired Connector	0.5m (Or None in the Case of No Switch)
Number	2 pcs.
-	Compressed air (non-lube)
Maximum operating pressure	1.0 MPa
Minimum operating pressure	0.1 MPa
Pneumatic input connection	G 1/4
Weight	4.200 Kg

Dimensions

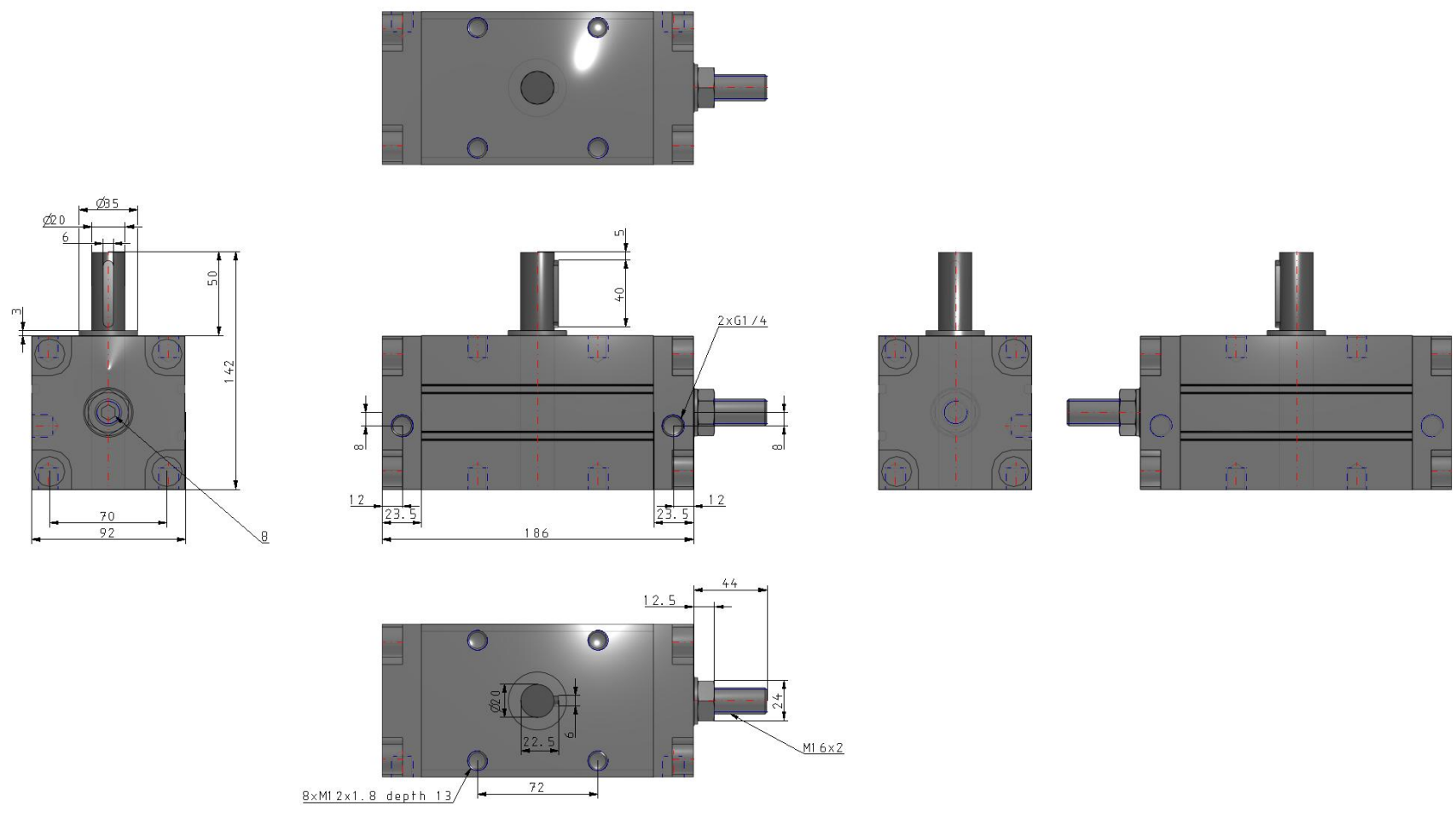

Specifications are subject to change without prior notice and any obligation on the part of the manufacturer.

Constructions

Construction

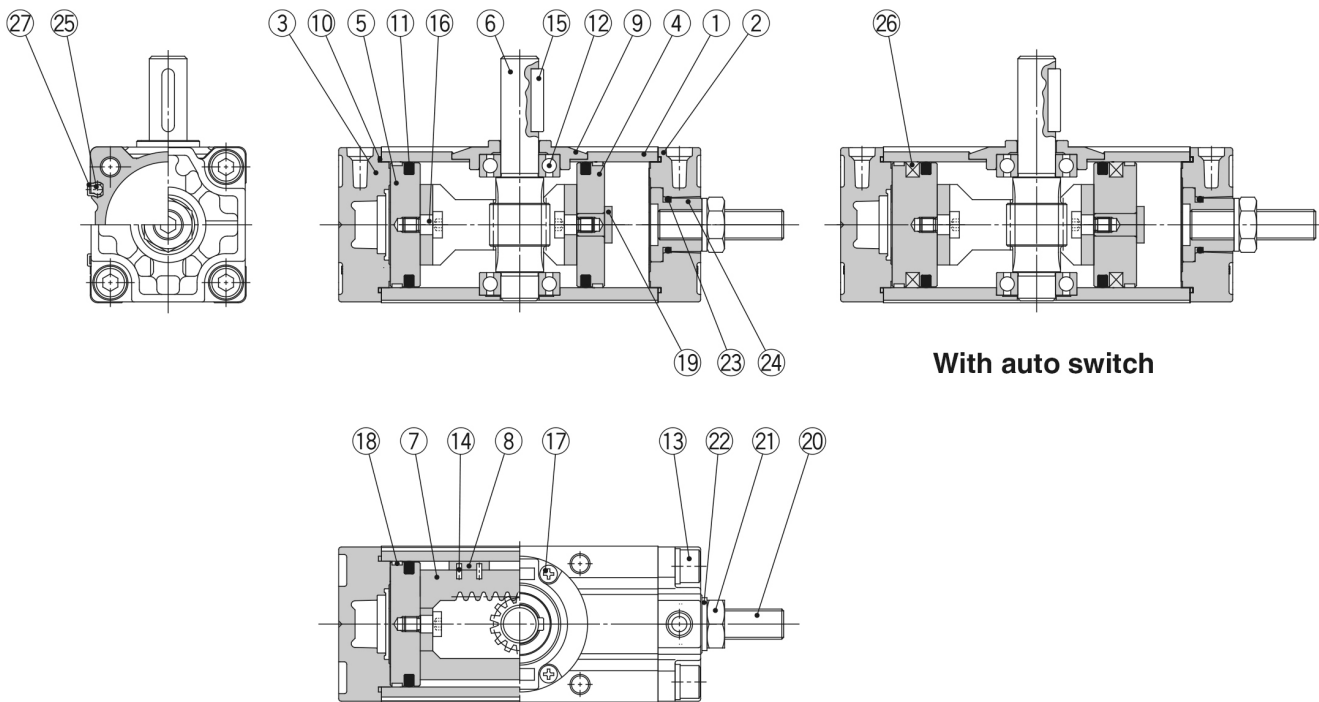

With auto switch

Component Parts

No.	Description	Material	Note
1	Body	Aluminium alloy	Anodised
2	Right cover	Aluminium alloy	Metallic coating
3	Left cover	Aluminium alloy	Metallic coating
4	Right piston	Aluminium alloy	
5	Left piston	Aluminium alloy	
6	Shaft	Alloy steel	
7	Rack	Carbon steel	Nitrided
8	Slider	Resin	
9	Bearing retainer	Aluminium alloy	Chromated
10	Tube gasket	NBR	
11	Piston seal	NBR	
12	Bearing	High carbon chrome bearing steel	
13	Hexagon socket head cap screw with washer	Alloy steel	Zinc chromated
14	Spring pin	Steel	Zinc chromated

No.	Description	Material	Note
15	Parallel key	Carbon steel	
16	Connecting screw	Carbon steel	Zinc chromated
17	Cross-recessed pan head tapping screw	Steel	Zinc chromated
18	Wear ring	Resin	
19	Stopper	Carbon steel	Zinc chromated
20	Hexagon socket head set screw (flat point)	Alloy steel	Zinc chromated
21	Hexagon nut	Steel	Zinc chromated
22	Seal washer	NBR	
23	O-ring	NBR	
24	Angle adjusting collar	Carbon steel	Zinc chromated
25	Auto switch	—	
26	Magnet	—	
27	Switch spacer	Resin	

Additional information

Catalogue

[CRA1-C-Z_EU.pdf](#)

Operation manuals

[OM_CRA1-Z_OM00006EN-E.pdf](#)